

**D** VHM-Entgrater, 90°

**Einsatzbereich:**  
Universeller Anwendungsbereich, besonders geeignet zum Anfasen und Entgraten sowie Konturarbeiten.



**E** Solid carbide deburring mills, 90°

**Range of application:**  
Universal range of application, especially suited for chamfering and deburring as well as contouring.

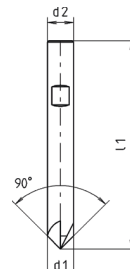

**I** Frese a smussare MDI, 90°

**Impiego:**  
Adatte per impieghi universali, particolarmente raccomandate per lavorazioni di smussatura, sbavatura ed anche di contornatura.



DIN 6535-HB



DIN 6535-HB

ALUNIT®

d1 <sub>h10</sub> mm	d2 <sub>h6</sub> mm	l1 mm	Z	Code 7755 Art.-Nr.	Code 7757 Art.-Nr.
4	4	54	4	0 7755004001 00	0 7757004001 00
6	6	57	4	0 7755006001 00	0 7757006001 00
8	8	63	4	0 7755008001 00	0 7757008001 00
10	10	72	4	0 7755010001 00	0 7757010001 00
12	12	83	4	0 7755012001 00	0 7757012001 00
16	16	92	6	0 7755016001 00	0 7757016001 00

Ø 4 kein Weldon-Schaft / Ø 4 no weldon shaft / Ø 4 no gambo Weldon



VHM-Fräser  
Solid carbide milling cutters  
Frese in metallo duro integrale